

## MULTIHOLES ROUND INSULATOR

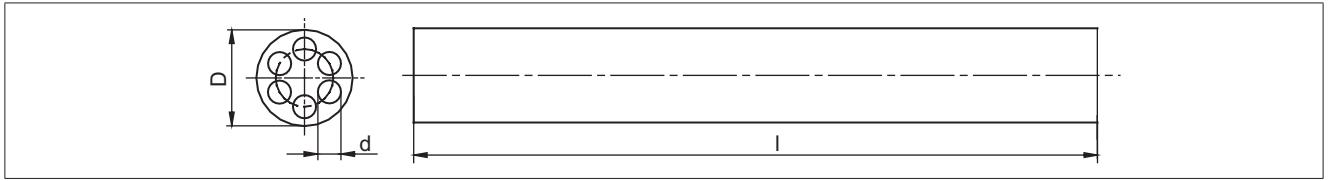

NUMBER OF HOLES	DIMENSIONS [mm]			MATERIAL	ORDER No.
	D	d	l		
6	6.0	1.0	1000	C 610	4 - L1689.1
6	4.5	0.9	1000	C 799	4 - L1689.2
8	5.0	0.8	1000	C 610	4 - L1689.3

## TWO HOLES ROUND INSULATOR

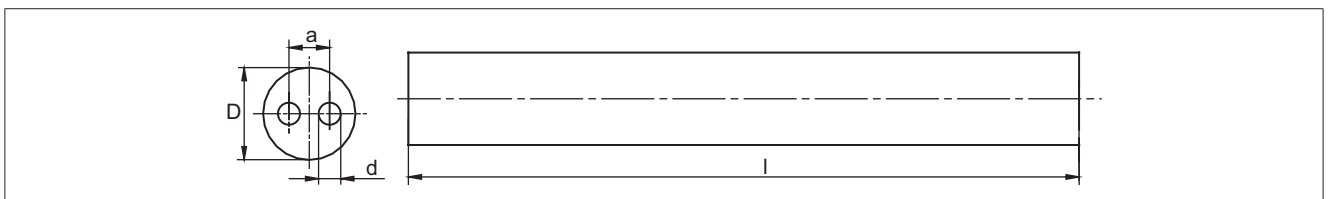

DIMENSIONS [mm]				MATERIAL AC. TO IEC 60672-3	ORDER No.
D	d	a	l		
Ø2.2	Ø0.75	1.05	12	C 130	4 - L0498
Ø2.5	Ø8	1.10	30	610	4 - 53515
			22		4 - 11729/1
Ø4	Ø1.25	1.85	60	C 220	4 - 11729/2
			15		4 - 11729/3
			30		4 - 11729/4
Ø5	Ø1.2	2.20	63	C 710	4 - 6262
Ø6.5	Ø1.5	2.90	10	C 220	4 - 5073.1
			20		4 - 5073.2
			40		4 - 5073.3
			60		4 - 5073.4
			80		4 - 5073.5
			120		4 - 5073.6

## FOUR HOLES ROUND INSULATORS

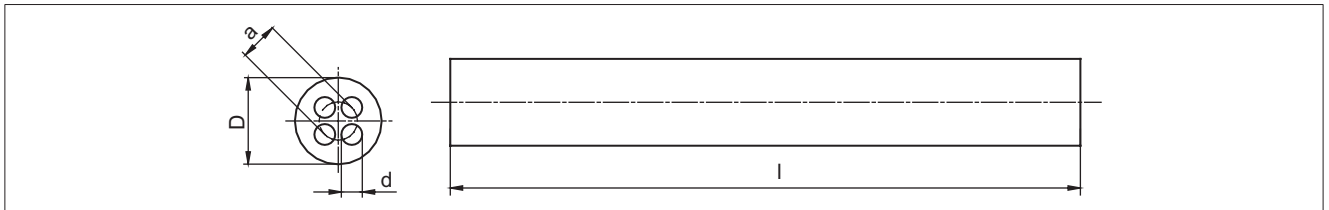

DIMENSIONS [mm]				MATERIAL AC. TO IEC 60672-3	ORDER No.
D	d	a	l		
Ø4.2	Ø1.2	2.4	50	C 220	4 - 37381.3
			10	C 220	4 - 37381.4
Ø5	Ø1.25	2.6	63	C 710	4 - 11728.1
			120	C 710	4 - 11728.3
Ø6	Ø1.5	3.1	100	C 220	4 - 37382.1
			10	C 220	4 - 37382.2
Ø15	Ø4	8.3	10	C 710	4 - 37392.1
			100	C 220	4 - 37398.2

CERAMIC INSULATORS, THERMOWELLS